

PARTS BOOK
FOR
brother® homelock
MODEL 524

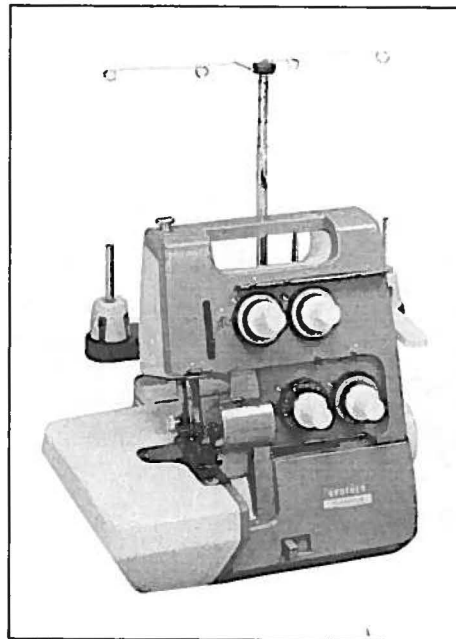

Please clarify Ref. No. and
Parts No. as well as parts name
When you place an order.

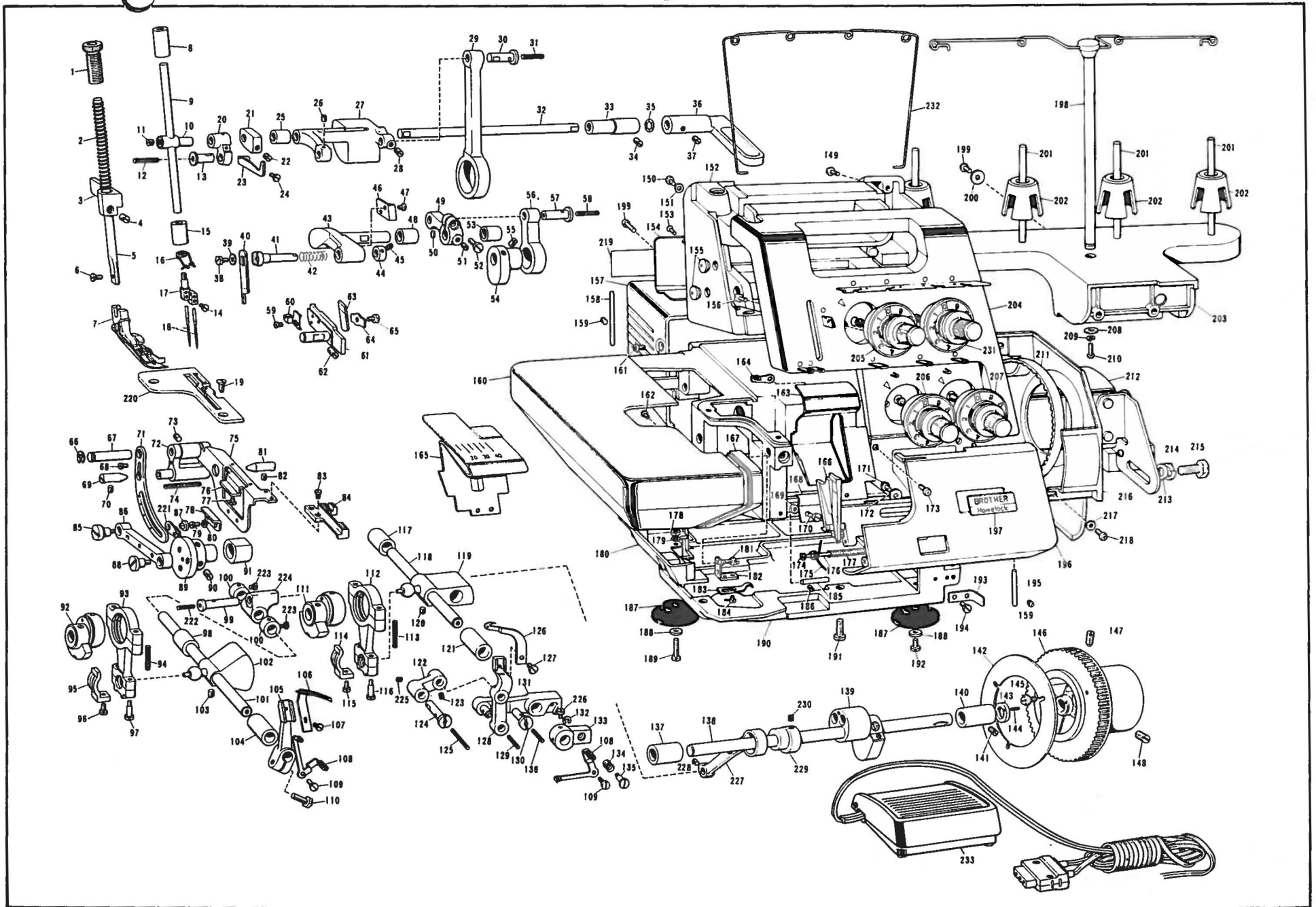

Ref. No.	Parts No.	Name of Parts	Ref. No.	Parts No.	Name of Parts	Ref. No.	Parts No.	Name of Parts	Ref. No.	Parts No.	Name of Parts
1	142860001	Presser Adjusting Screw	63	126601001	Lower Knife	125	112373001	Wick	187	126540000	Cushion
2	126662001	Presser Bar Spring	64	117515001	Lower Knife Presser Plate	126	126643001	Spreader	188	025710232	Washer, 4.76
3	147080001	Presser Bar Bracket	65	117516001	Bolt, 4.37	127	009670814	Set Screw, 3.57 X 8	189	107423001	Set Screw, 4.76 X 15
4	100058003	Set Screw, 5.95	66	048050342	Stopper Ring, E5	128	126640001	Looper Link	190	126539001	Oil Pan
5	126660001	Presser Bar	67	126584000	Feed Bar Shaft	129	117429001	Felt	191	009781412	Set Screw, 6.35 X 14
6	009670814	Set Screw, 3.57 X 8	68	009670512	Set Screw, 3.57 X 5	130	126641001	Looper Link Stud	192	142957001	Set Screw, 4.76 X 8
7	123474001	Presser Foot Assembly	69	102436001	Center Pin	131	126633001	Looper Guide Lever	193	126525001	Front Cover Guide Plate
8	126702000	Needle Bar Bushing, Upper	70	123445001	Set Screw, 4.76	132	048030342	Stopper Ring, E3	194	009660612	Set Screw, 3.18 X 6
9	126568001	Needle Bar	71	126789001	Feed Adjusting Lever	133	126638001	Looper Change Lever	195	126524001	Front Cover Pin
10	126656001	Needle Bar Connecting Stud	72	126583000	Feed Bar Lever	134	126808001	Spring	196	126516001	Front Cover
11	100289602	Set Screw, 5.95	73	123445001	Set Screw, 4.76	135	126800001	Set Screw, 4.76	197	126553001	Name Plate
12	117429001	Felt	74	142869000	Feed Lever Wick	136	117429001	Felt	198	126691001	Spool Stand Assembly, 4
13	142827001	Needle Bar Link Shaft	75	126574001	Feed Bar	137	142818000	Driving Shaft Bushing, Left	199	002401204	Set Screw, 4 X 12
14	009660414	Set Screw 3.18 X 4	76	126576001	Feed Adjusting Block, Upper	138	126557000	Driving Shaft	200	025040332	Washer, M4
15	126703000	Needle Bar Bushing, Lower	77	009670512	Set Screw, 3.57 X 5	139	126714001	Needle Bar Eccentric Wheel Assembly	201	142914001	Spool Pin
16	126713001	Needle Bar Thread Guide	78	126577001	Feed Adjusting Block, Lower	140	126558000	Driving Shaft Bushing, Right	202	147060000	Spool Cushion
17	142833001	Needle Bracket	79	009670512	Set Screw, 3.57 X 5	141	123445001	Set Screw, 4.76	203	126694000	Spool Stand Base, 4
18	142935014	Needle, TE X 1	80	028040242	Spring Washer, 4	142	126563001	Timing Pulley Plate	204	126502001	Panel Assembly, 4
19	100032003	Set Screw, 4.37	81	116605001	Center Pin	143	126571001	Washer	205	126788001	Needle Tension Dial Assembly, A
20	126657000	Needle Bar Connecting Link	82	123445001	Set Screw, 4.76	144	047160640	Spring Pin, AW1.6	206	126684001	Double Chain Thread Tension Dial Assembly
21	126661001	Presser Lifter Cam	83	100080004	Set Screw, 3.18	145	126767001	Set Screw, 3.57			
22	013680810	Set Screw, 4.37	84	126599001	Feed Dog, C	146	126562001	Timing Pulley	207	126665001	Spreader Thread Tension Dial Assembly
23	126712001	Thread Take-up	85	126586001	Feed Adjusting Knob	147	103950001	Set Screw, 5.95			
24	009670512	Set Screw, 3.57 X 5	86	126581001	Feed Link	148	013761013	Set Screw, 5.95	208	025040332	Washer, M4
25	142822000	Driving Shaft Bushing, Left	87	126587001	Feed Adjusting Nut	149	037401214	Screw, 4 X 12	209	028040242	Spring Washer, M4
26	123445001	Set Screw, 4.76	88	126582001	Feed Link Stud Screw	150	009680514	Set Screw, 4.37 X 5	210	002401204	Set Screw, 4 X 12
27	126566000	Needle Bar Driving Lever	89	126580001	Feed Eccentric Wheel	151	142932000	Washer	211	126533000	Timing Belt
28	123445001	Set Screw, 4.76	90	013750812	Set Screw, 5.56	152	126501001	Machine Body	212	131	Motor
29	126564000	Needle Bar Rod	91	126578000	Vertical Feed Adjusting Block	153	106202002	Set Screw, 3.18	213	100197004	Washer
30	126565001	Rod Shaft	92	126645001	Double Chain Looper Eccentric Wheel	154	126537000	Rear Cover	214	203735001	Spring Washer
31	126592000	Wick	93	126606001	Double Chain Looper Rod	155	114255001	Cap	215	103741001	Bolt, 7.14
32	126567000	Driving Shaft	94	126592000	Wick	156	009681212	Set Screw, 4.37 X 12	216	126534001	Belt Cover
33	147085000	Driving Shaft Bushing, Right	95	126608000	Looper Joint Guide	157	126536000	Motor Cover	217	025040332	Washer, M4
34	123445001	Set Screw, 4.76	96	009670712	Set Screw, 3.57 X 7	158	126532001	Hinge Pin	218	002400804	Set Screw, 4 X 8
35	120265001	Spring Washer	97	126781001	Bolt, 4.37 X 14	159	013679312	Set Screw, 3.57	219		Model Plate
36	126653001	Presser Bar Lifter	98	126611000	Looper Shaft Bushing, Rear	160	126528001	Cloth Plate Cover	220	126733001	Needle Plate C
37	102716003	Set Screw, 4.37	99	142883001	Double Chain Rod Shaft	161	002400804	Set Screw, 4 X 8	221	126797000	Feed Adjusting Stopper
38	144075001	Bolt, 3.57	100	142871001	Lever Collar	162	009670512	Set Screw, 3.57 X 5	222	117429001	Felt
39	105161003	Washer	101	126647000	Double Chain Looper Shaft	163	126523001	Front Cover, C	223	111443001	Set Screw 3.57
40	126598001	Upper Knife	102	126699001	Under Looper Joint	164	126710001	Looper Thread Guide	224	142884001	Lever
41	126769001	Upper Knife Holder	103	013750812	Set Screw, 5.56	165	126761001	Front Cover for Double-Chain-Stitch	225	123445001	Set Screw 4.76
42	123435001	Upper Knife Presser Spring	104	126610000	Looper Shaft Bushing, Front	166	126517000	Front Cover Guide	226	104908002	Set Screw 4.37
43	126768001	Upper Knife Driving Lever, C	105	126625000	Under Looper Lever	167	126531000	Cloth Plate Side Cover	227	126651000	Double Chain Rod
44	147092001	Upper Knife Holder Guide	106	126648001	Double Chain Looper Assembly	168	126521001	Front Cover Spring Plate	228	123445001	Set Screw 4.76
45	013679312	Set Screw, 3.57	107	009670512	Set Screw, 3.57 X 5	169	021300302	Nut, 3	229	147079000	Double Chain Rod Cam
46	126597001	Upper Knife Holder Guide Plate	108	126709001	Looper Thread Take-up	170	002309402	Set Screw, 3 X 4.5	230	107053001	Set Screw 4.76
47	009660612	Set Screw, 3.18 X 6	109	009670512	Set Screw, 3.57 X 5	171	007679302	Set Screw, 3.57 X 3.5	231	126664001	Needle Thread Dial Assembly B
48	126595000	Driving Lever Bushing, Left	110	126765001	Bolt, 4.76 X 12	172	025350332	Washer, 3.5	232	126806001	Thread Guide A
49	126591000	Upper Knife Driving Lever	111	126630001	Looper Rod Eccentric Wheel	173	002400804	Set Screw, 4 X 8	233	141	Controller
50	123445001	Set Screw, 4.76 X 12	112	126608000	Looper Rod	174	048020346	Stopper Ring, E2			
51	013750812	Set Screw, 5.56	113	126592000	Wick	175	126520001	Front Cover Stopper Spring			
52	100320003	Set Screw, 4.76	114	126608000	Looper Joint Guide	176	126518000	Front Cover Guide Shaft			[Accessories, etc.]
53	126594000	Driving Lever Bushing, Right	115	009670712	Set Screw, 3.57 X 7	177	126519000	Front Cover Spring		126737001	Vinyle Bag for Accessories
54	126556000	Upper Knife Eccentric Wheel	116	126781001	Bolt, 4.37 X 14	178	105367002	Nut, 4.76		122739001	Screw Driver, 5.5 X 75
55	013750812	Set Screw, 5.56	117	126611000	Looper Shaft Bushing, Rear	179	025710232	Washer, 4.76		117466000	Pinsette
56	126590000	Upper Knife Driving Link	118	126632000	Looper Shaft	180	126742000	Oil Pan Side Cover		123443001	Needles Set
57	126565001	Rod Shaft	119	126731001	Looper Joint	181	009670512	Set Screw, 3.57 X 5		121152001	Oiler Assembly
58	126592000	Wick	120	013750812	Set Screw, 5.56	182	126529001	Spring Fixing Plate		142934001	Machine Brush
59	009660414	Set Screw, 3.18 X 4	121	126610000	Looper Shaft Bushing, Front	183	126530001	Cloth Plate Cover Spring Plate		142603001	Spool Cap
60	126759001	Needle Guard	122	126642001	Guide Lever	184	007679302	Set Screw, 3.57 X 3.5		192541011	Instruction Book (English)
61	126600001	Lower Knife Holder, C	123	123445001	Set Screw, 4.76	185	126526001	Front Cover Stopper Shaft		126735001	Machine Cover
62	013761012	Set Screw, 5.95	124	126799001	Guide Lever Stud	186	013660812	Set Screw, 3.18			